

# Manatee Bay

**2 Bedroom 2 Bath**

**1,492 Square Feet**

**Starting at \$1,370**

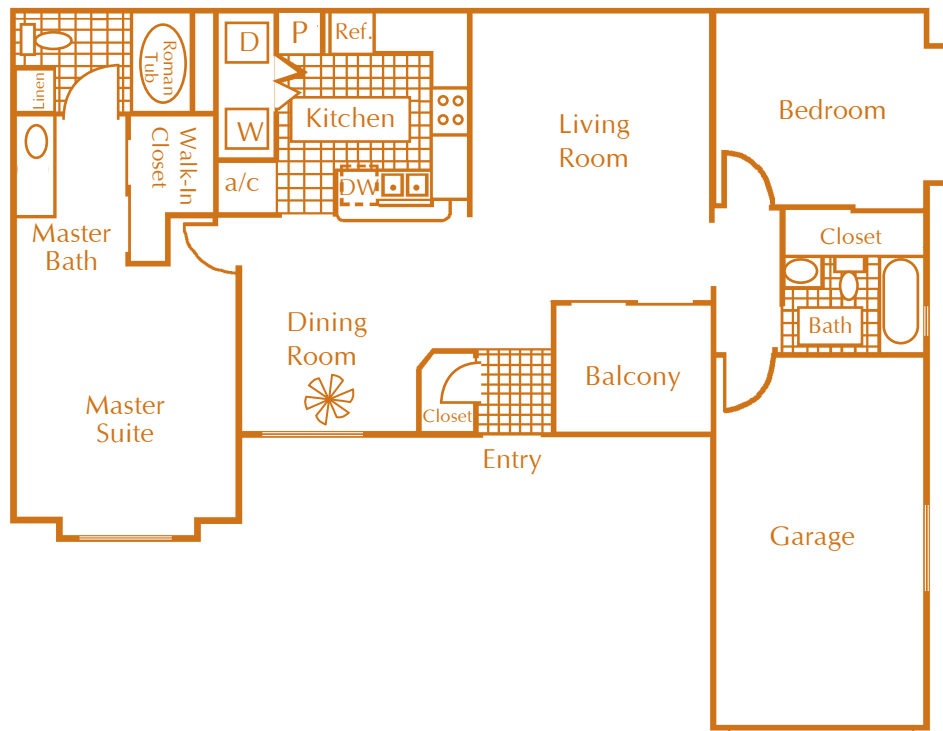

## INTERIOR FEATURES

- **INTRACOASTAL AND LAKEFRONT VIEWS AVAILABLE**
- **SPACIOUS 1,2 & 3 BEDROOM APARTMENT HOMES**
- **2 BEDROOM APARTMENT HOMES WITH ATTACHED GARAGE**
- **AUTOMATED GATE ACCESS**
- **INDIVIDUAL ENTRANCES**
- **FULLY APPOINTED KITCHEN**
- **FULL SIZE WASHER AND DRYER**
- **DECORATIVE CERAMIC TILE ENTRY, KITCHEN AND BATH**
- **CEILING FAN IN DINING AREA**
- **MARBLE ROMAN TUB**
- **SPACIOUS WALK IN CLOSET**
- **SCREENED PATIO OR BALCONY**

## RECREATIONAL FEATURES

- **MARINA WITH BOAT SLIPS AVAILABLE**
- **DIRECT BOAT ACCESS TO THE BOYNTON INLET**
- **GRAND SALON LOCATED ON THE INTRACOASTAL**
- **MEDIA CENTER WITH GAME TABLES**
- **STATE OF THE ART FITNESS CENTER**
- **HISTORIC NATURE PRESERVE WITH SCENIC WALKING TRAIL**

## INTRACOASTAL FEATURES

- **PRIVATE WHITE SAND BEACH**
- **WATERFRONT POOL AND BAR**
- **BBQ AREA**
- **SPECTACULAR VIEWS AVAILABLE**

PRICES SUBJECT TO CHANGE WITHOUT NOTICE

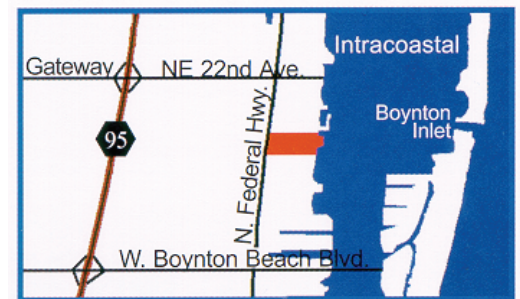

**MON, WED & FRI: 8AM-6PM**

**TUES & THURS: 8AM-8PM**

**SAT & SUN: 9AM-6PM**

**MANATEE BAY**

**1632 NORTH FEDERAL HIGHWAY  
BOYNTON BEACH, FLORIDA 33435**

**PHONE: 561.735.4141**

**FAX: 561.691.0329**

**WWW.MANATEEBAYAPARTMENTS.COM**